



Innovation | High end technology | World class performance ...

Technical Brochure
**Sight Flow
Indicators**



INTRODUCTION

Synflo Sight Flow Indicators provide clear, continuous and unobstructed visibility of process conditions, products and liquid levels.

Synflo Sight Flow Indicators are quick & easy to install, provide full 360° viewing area, are reliable in operation and provide the means for early detection & response that can help prevent costly downtime.

Quality

- High end world class performance
- Quality system in accordance with ISO 9001
- Complete material traceability & interchangeability is maintained
- Material / Pressure test certificates available on request

Application

Synflo Model SG sight flow indicators are best suited for vertical installations, and are recommended for low pressure applications, where maximum visibility is necessary to effectively monitor fluid dynamics.

Salient Features

- Full 360° viewing area
- High quality design
- Quick & easy to install
- Investment Cast ANSI 150 Class Flanges
- Provides reliable clear viewing quality
- Available Ex-stock
- Low Maintenance

Size Available

25 mm (1"), 40 mm (1 ½"), 50 mm (2"),
65 mm (2 ½"), 80 mm (3"), 100 mm (4"),
150 mm (6")



TECHNICAL DATA

Standard Design

Synflo Sight Indicators consists of four basic components :

Base Flange

Base flanges are accurately machined to provide a recess for glass fitment & also provides an effective method of compressing and sealing gaskets on the glass ends to prevent leakage.

Sealing Gasket

Sealing Gasket is placed in the recess provided in the body and is compressed by studs and nuts to effectively seal the gap and prevent leakage between the flange & glass tube.

Glass Tube

Annealed borosilicate glass tubes are installed in series with the pipe line that is under observation and is a vital component of sight flow indicator.

Stud / Stud Nuts

Stud Nuts compress the glass tube between the flanges and provide rigidity to the sight flow indicator.

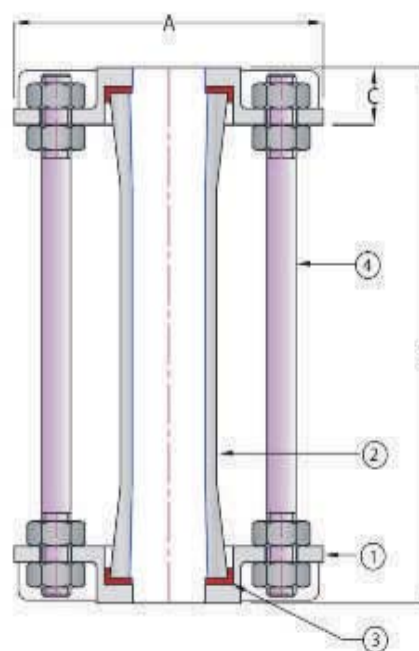
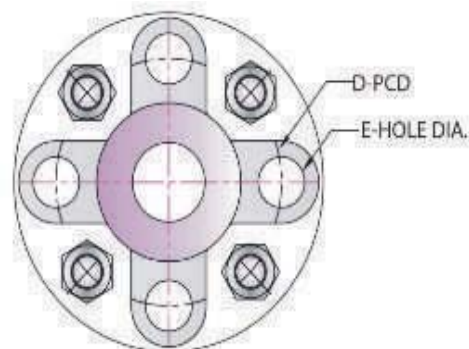

Materials of Construction

Sr.	Part Name	Material of Construction
1.	Base Flanges	ASTM A216 Gr. WCB AST MA 351 Gr. CF8 ASTMA 351 Gr. CF8M
2.	Glass	Annealed Borosilicate
3.	Gaskets	PTFE*
4.	Studs & Nuts	A 270**

* Glass filled PTFE, other special gaskets available on request

** SS 304 / 316 studs & nuts available on request

A - Flange Diameter

B - Face to Face

C - Flange Thickness

D - PCD

E - Hole Diameter

F - No. of Holes

PART NAME

SR. DESCRIPTION

1 BASE FLANGE

2 GLASS TUBE

3 GASKET

4 STUDS / NUTS

Dimensions & Weight

MODEL	SIZE (mm)	DIMENSIONS (mm)						WEIGHT (kg)
		A	B*	C	D	E	F	
SG-25	25	107.9	162	15	79.4	16	4	1.5
SG-40	40	127.0	165	15	98.4	16	4	2
SG-50	50	152.4	170	17	120.6	19	4	2.9
SG-80	80	190.5	175	20.5	152.4	19	4	5.2
SG-100	100	228.6	175	20.5	190.5	19	8	8.2
SG-150	150	279.4	175	20.5	241.3	22.2	8	11.5

*Face to face length shall be ± 3 mm

Operating Conditions

- Pressure upto 6 Bar in operating conditions
- Temperatures from -20°C to 210°C . in operating conditions

INSTALLATION/OPERATION, SPARES & MAINTENANCE

Installation / Operation

DO'S

- Ensure only qualified & experienced personnel familiar with this equipment undertakes installation.
- Examine the glass tube visually and ensure it is free of all imperfections.
- Follow standard installation procedures.
- Check all connections are pressure tight.

DONT'S

- Never exceed the design pressure ratings.
- Do not impose system piping loads on sight flow indicators.
- Do not install the equipment where there are large temperature variations.
- Avoid excessive shock or stress on glass while bringing the equipment to service.

Ordering Data

When ordering, please state the following :

- DN Size
- Material of construction
- Specific application, if any
- Pressure Rating

Maintenance

Create maintenance schedules to regularly evaluate the following :

- Glass tube for cleanliness and signs of crack, damage or wear.
- Check for any signs of leakage at gasket or at connections.
- Check for any signs of internal / external corrosion.

Spares

Keep limited numbers of viewing glass and gaskets in your maintenance stocks, based on your usage. Use only genuine spares for interchangeability and reliability.



Corporate Office :

SYNFLO VALVES PVT. LTD.

4/B. Vikasnagar, B/h HOEC,
Off Old Padra Road,
Baroda-390 005,
Gujarat, India.
Tel : +91 265 2341784/85
Fax : +91 265 2341869
Mobile : 98240 17377, 98240 32594
E-mail : info@synflovalves.in
Website : www.synflovalves.in

Works :

Plot # 26-27, Dev Industrial Estate,
Gorwa, Baroda-390016, Gujarat, India.